

CONTOUR

Shower Enclosure Fitting Instructions

PLEASE READ BEFORE BEGINNING YOUR INSTALLATION. THESE INSTRUCTIONS HAVE BEEN PREPARED AS A GUIDE AND ALSO AIM TO ASSIST IN THE INSTALLATION OF ANY SPECIAL ENCLOSURES OR DOOR CONFIGURATIONS.

THESE INSTRUCTIONS ARE SUITABLE FOR OUR STANDARD & LUXÉ RANGE OF SHOWER ENCLOSURES, SOME BRACKETRY WILL BE GREY TO COMPLIMENT THE LUXÉ RANGE.

IN THE CASE OF ANY DIFFICULTIES BEING ENCOUNTERED, PLEASE DO NOT HESITATE TO CONTACT OUR TECHNICAL DEPARTMENT ON **0845 402 9924**.

1	Shower Enclosure
2	Shower Curtain (Not supplied with Made to Measure enclosures that do not incorporate a vertical support pole unless ordered)
3	Curtain Rail with Hooks & Gliders (Not supplied with Made to Measure enclosures that do not incorporate a vertical support pole unless ordered)
4	Shower Enclosure Fixing Pack (Your fixing pack may have parts over once your enclosure is assembled as this is a universal fixing pack)

DO ✓



READ these instructions before starting your installation. These instructions will help with the fitting of your shower enclosure.



POSITION the complete enclosure roughly on the shower tray with the doors closed to judge where the enclosure is to be fitted.



24 hours

It is **ESSENTIAL** all joints between compensators, walls, panels and shower tray, both sides, are silicone sealed and left to cure for 24 hours.

DON'T ✗



We **DO NOT** approve the use of power showers with our shower trays.



NO responsibility will be accepted by the manufacturer for water leaks, or any other fault, if these instructions have not been followed.

IMPORTANT:

The shower head should be positioned towards the users standing / sitting position and **NOT** towards the doors.



Place compensators against wall ensuring that they rest on the flat area of the tray or floor at the position shown. Mark off fixing holes on wall when level.



If fitting your enclosure on a wet floor, a corner block at the base of each compensator can be shaped at 10mm or 38mm radius to accept floor coving. Cut along pre-formed indents.



Drill holes in wall with a No10 masonry drill, insert wall plugs, and fix with No8 x 50mm pan head self tapping screws.

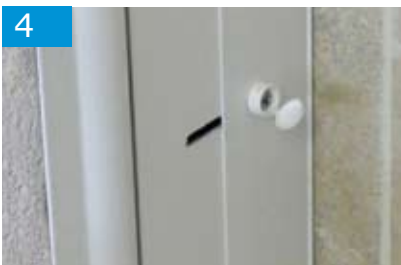

Offer doors / fixed panel into their respective compensators ensuring that the slots engage with adjusting screws.

IF INSTALLING AN OPTION WITH A VERTICAL SUPPORT POLE PLEASE SEE STEPS 11 - 14.



Fully close doors so that magnetic profiles come together. Ensure they are parallel for the full height of the door(s).

Adjust compensators for out of plumb walls and to obtain the correct position of doors relative to the tray or shower area.



Ensure that the rubber seal on the bottom of the door(s) is slightly compressed against the tray surface or floor.



Our **NEW** 2 part rise & fall hinge has been designed to make our doors more stable. The hinge locator screws to the tray or floor and will fit into the centre of the recess underneath the hinge, as demonstrated above.

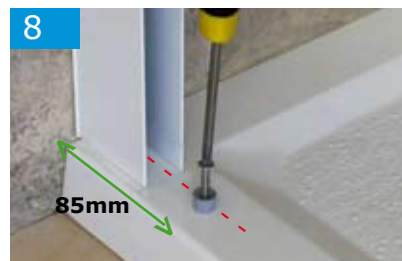

Find the centre point between the compensator. Measure 85mm and pilot drill a 3mm hole. Fix hinge locator to the tray or floor with No8 x 25mm countersunk screw.



Offer the doors back into their respective compensators. Fully tighten compensator adjusting screws on the inside of the compensator when doors are aligned.

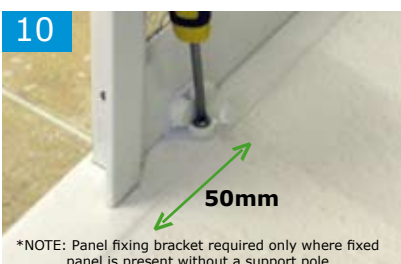

*NOTE: Panel fixing bracket required only where fixed panel is present without a support pole

Mark hole through panel fixing bracket onto tray or floor & bottom rail (when door and / or fixed panel are inline). Pilot drill and fix bracket in place using self tapping screws and white caps provided.



OPTIONS WITH A VERTICAL SUPPORT POLE:
Insert the panel in the compensator as Step 4, mark around the post(s) to ascertain the location for the post block(s) when the panels are in the correct position.



Find the centre point for the post block(s) and pilot drill a 3mm hole. Fix block in position with No8 x 25mm pan head screws.

13



Place a small amount of silicone sealant around the post block(s) and re-fit panel assemblies in position. Fully tighten compensator adjusting screws to secure in position, as shown in Step 9.

14



If fitting a post compensator, inline or off a return panel, place the compensator against the post and mark through the fixing slots. Find the centre of your mark and drill a 3.8mm diameter hole. Fix in place with No8 x 25mm pan head self tapping screws.

Offer door into post compensator as described in steps 4 to 8.

15



If fitting a floor to ceiling post, measure from the tray / floor to the ceiling and cut post to suit. Fit the post block as in steps 11 to 13.

Ensure the post is level using a spirit level, mark the position for the ceiling rose and fix to ceiling using a suitable type fixing (not supplied).

16



Place door handle(s) against leading edge of door(s) on the top rail. Pilot drill 3.3mm diameter holes, and fix handle to door with self tapping screws. Fit blanking caps, see inset image.

17



On completion of building the unit, fix locking screws and caps into compensators. Pilot drill through pre-drilled holes in the outside of the compensator with a 3.0mm diameter drill and secure in position with the supplied screws.

18



Place panel support bracket against wall and just below top edge of top rail (Approx 5mm), on the inside of the enclosure.

Mark & pilot drill holes on the rail & wall and fix the bracket in position with the supplied screws.

19



Place compensator top caps on top of the compensator. It should 'click' positively in position.

20

To fit curtain rail, firstly determine the height required, For example: 'A' = 1885mm.

Mark off two holes onto wall through each curtain rail wall bracket.

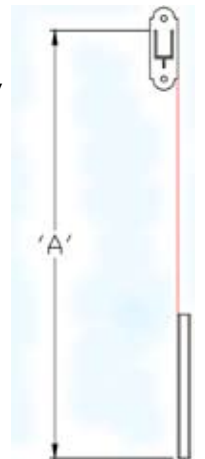

The bottom of the curtain should be just above the trays surface

21



Drill wall with a No10 masonry drill, insert wall plugs and fix with No8 x 50mm pan head self tapping screws and caps.



Cut curtain rail to size, if required, with a hacksaw. Any rough edges should be filed smooth

22

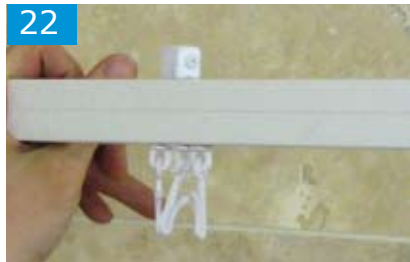

Fit the hooks and gliders to the underside of curtain rail and the rail connector to the top side. **NOTE:** Rail connector used when rail is supported from the ceiling without a vertical support pole.

23



Place curtain rail into wall brackets. Mark holes onto curtain rail through wall bracket and pilot drill rail with a 3.0mm diameter drill.



Secure curtain rail into wall brackets with No8 x 13mm pan head self tapping screws and caps.



Mark position for ceiling rose and fix to ceiling using a suitable fixing (not supplied). Cut drop rod to length.



Secure drop rod into ceiling rose and rail connector into the top side of the curtain rail by tightening their respective fastening screws.



Washers supplied to be used as spacers between panel & rail, see inset image below

FULL HEIGHT FIXED PANEL:
Fix curtain rail to panel by placing rail against the top inside edge of the panel. Drill a 3.5mm hole in panel top rail & post through curtain rail. Fix rail to panel with No8 x 25mm screws and caps and to post using No8 x 38mm screw, as in Step 30.



WHERE VERTICAL SUPPORT POLE IS PRESENT:
With the curtain rail in position, guide the post extension over the post spigot and secure in position with the supplied grub screw. Depending on your enclosure type you will secure the post to the curtain rail or using a boomerang bracket.

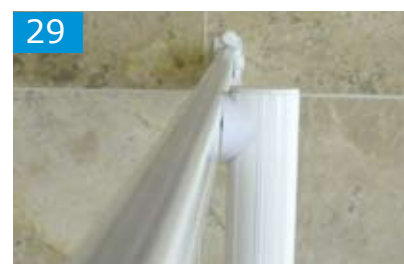

It may be necessary to trim the top of the post extension so that it finishes flush with the top of your curtain rail.

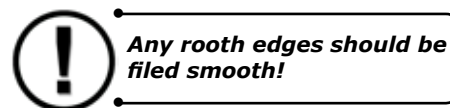

Any rough edges should be filed smooth!



Ensuring the post is straight, pilot drill through both the curtain rail and post using a 3.0mm drill. Screw both together with a No8 x 38mm pan head screw and cap.



Make certain that the shaped plastic washer is fitted in between the post and the rail before fixing. Place the supplied post cap into the top of the post.



Place boomerang bracket in the top of the post, pilot drill holes in the rails top channel and fix to the post through the pre-drilled holes. **REMOVE PLASTIC DUST COVER FIRST.**



Screw the boomerang bracket to the curtain rail using the No6 x 3/4" countersunk screws. **USE SCREWS PROVIDED.**



IMPORTANT:
Seal all joints between compensators, walls, panels and shower tray or floor, on the inside and outside of the shower area using silicone sealant.



Fit your shower curtain to the hooks and gliders on the curtain rail.